

Change-over zone valve, 3-way,
Internal thread

- For closed cold and warm water systems
- For switching functions on the water side and 2-point controls in air handling units and heating systems
- Snap-assembly of the actuator



Type overview

Type	DN []	Rp ["]	kvs [m³/h]	PN []
C315Q-H	15	1/2	2.5	16
C320Q-J	20	3/4	4	16

Technical data

Functional data	Media	Cold and warm water, water with glycol up to max. 50% vol.
	Medium temperature	2...90 °C
	Permissible pressure ps	1600 kPa
	Closing pressure Δp_s	350 kPa
	Differential pressure Δp_{max}	280 kPa
	Differential pressure note	50 kPa for low-noise operation
	Leakage rate	Leakage rate A, tight (EN 12266-1)
	Pipe connectors	Internal thread according to ISO 7-1
	Angle of rotation	90°
	Installation position	Upright to horizontal (in relation to the stem)
	Maintenance	Maintenance-free
Materials	Housing	Brass body
	Closing element	Chrome-plated brass
	Stem	Brass
	Stem seal	O-ring EPDM
	Valve seat	PTFE, O-ring EPDM

Safety notes



- The valve has been designed for use in stationary heating, ventilation and air-conditioning systems and is not allowed to be used outside the specified field of application, especially in aircraft or in any other airborne means of transport.
- Only authorised specialists may carry out installation. All applicable legal or institutional installation regulations must be complied during installation.
- The valve does not contain any parts that can be replaced or repaired by the user.
- The valve may not be disposed of as household refuse. All locally valid regulations and requirements must be observed.
- When determining the flow rate characteristic of controlled devices, the recognised directives must be observed.

Product features

Principle of operation	The change-over zone valve is adjusted by a rotary actuator. The rotary actuator is controlled by an open-close signal.
Simple direct mounting	Tool-free snap-assembly The actuator can be plugged to the valve with hand pressure (Caution! vertical movement only). Pins must match the holes on the flange. The mounting orientation in relation to the valve can be selected in 180° increments. (possible 2 x)

Accessories

	Description	Type
Mechanical accessories	Spindle extension CQ	ZCQ-E

Installation notes

Recommended installation positions The ball valve can be installed upright to horizontal. The ball valve may not be installed in a hanging position, i.e. with the stem pointing downwards.

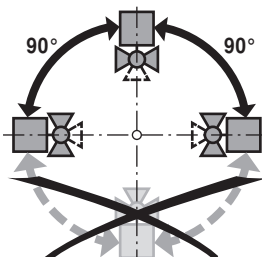

Water quality requirements The water quality requirements specified in VDI 2035 must be adhered to. Belimo valves are regulating devices. For the valves to function correctly in the long term, they must be kept free from particle debris (e.g. welding beads during installation work).

The installation of suitable strainer is recommended.

Maintenance Ball valves and rotary actuators are maintenance-free. Before any kind of service work is carried out on the actuator, it is essential to isolate the rotary actuator from the power supply (by unplugging the electrical cable). Any pumps in the part of the piping system concerned must also be switched off and the appropriate slide valves closed (allow everything to cool down first if necessary and reduce the system pressure to ambient pressure level). The system must not be returned to service until the ball valve and the rotary actuator have been properly reassembled in accordance with the instructions and the pipeline has been refilled in the proper manner.

Flow direction Flow possible in both directions.

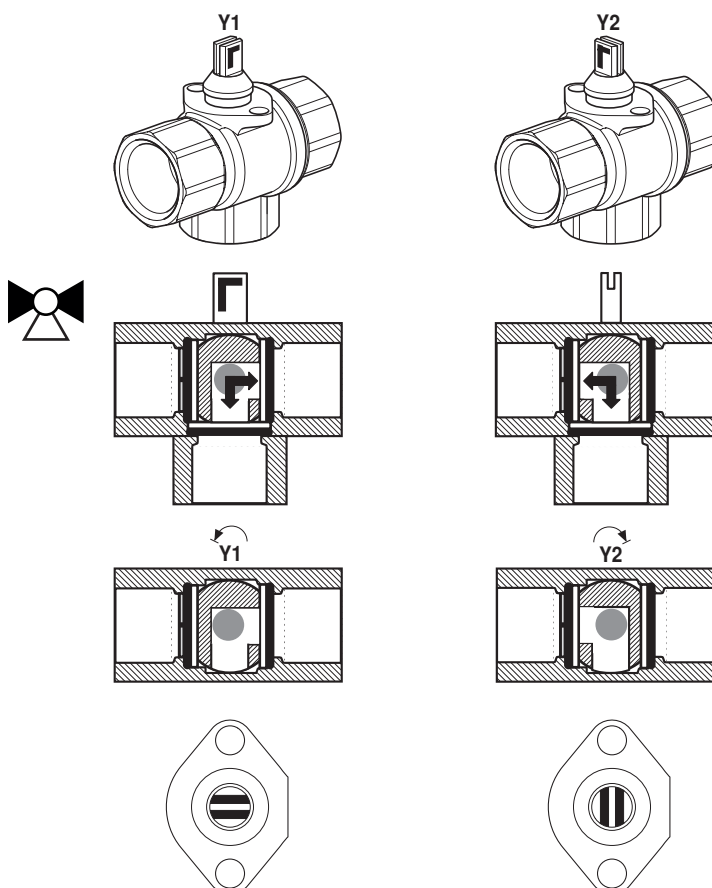

Installation notes

kv setting At the actuator the end stop clip has to be removed. This in order to get the angle of rotation of 90°, which is needed for the change-over functionality.

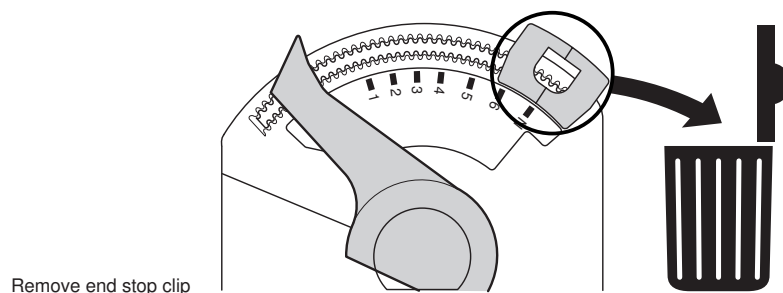

Dimensions / Weight

Dimensional drawings

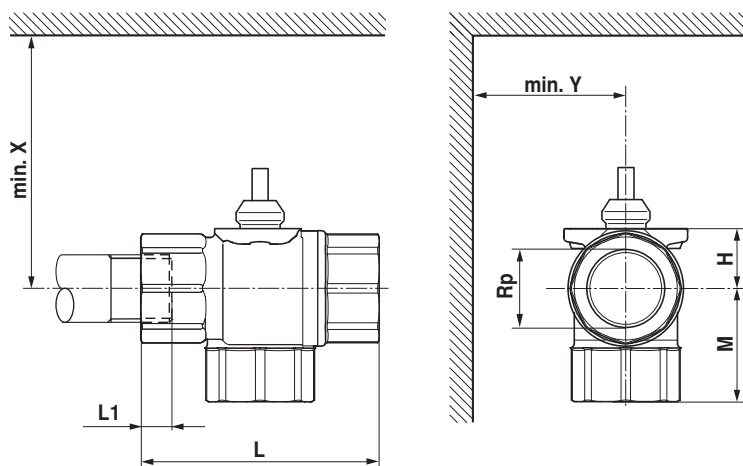

L1: Maximum screwing depth.

X/Y: Minimum distance with respect to the valve centre.

The actuator dimensions can be found on the respective actuator data sheet.

Type	DN []	Rp ["]	L [mm]	L1 [mm]	M [mm]	H [mm]	X [mm]	Y [mm]	Weight approx. [kg]
C315Q-H	15	1/2	58	13	32	14.5	110	35	0.21
C320Q-J	20	3/4	70	14	36	16.5	110	35	0.29

Further documentation

- Overview Valve-actuator combinations
- Data sheets for actuators CQ..
- Installation instruction for zone valves and actuators
- General notes for project planning